

PRODUCT SPECIFICATION FOR TURNED CLOSED CRIMP BARREL CONTACTS 40A

1.0 SCOPE

This Product Specification defines the performance for all turned closed crimp barrel contacts 40A.

2.0 PRODUCT DESCRIPTION

2.1 PRODUCT NAME AND SERIES NUMBER(S)

The products are turned closed crimp barrel contacts that carry 40 A nominal current. They could be silver or gold-plated and female or male type.

The Engineering part number is composed by 11 digits as follows:

Series		Progressive number		Plating type
7600	.	57XX	.	Y

0 : Silver
1 : Gold

The part numbers are reported below in table 1:

Engineering No.	Material no.	Description	Wire section [mm ²]	AWG section
7600.5700.0	0936010406	40A Female contact x 1 5 mm ² wire Silver	1.50	16
7600.5700.1	0936010407	40A Female contact x 1 5 mm ² wire Gold	1.50	16
7600.5701.0	0936010408	40A Female contact x 2 5 mm ² wire Silver	2.50	14
7600.5701.1	0936010409	40A Female contact x 2 5 mm ² wire Gold	2.50	14
7600.5702.0	0936010410	40A Female contact x 4 mm ² wire Silver	4.00	12
7600.5702.1	0936010411	40A Female contact x 4 mm ² wire Gold	4.00	12
7600.5703.0	0936010412	40A Female contact x 6 mm ² wire Silver	6.00	10
7600.5703.1	0936010413	40A Female contact x 6 mm ² wire Gold	6.00	10
7600.5704.0	0936010414	40A Female contact x 10 mm ² wire Silver	10.00	7
7600.5704.1	0936010415	40A Female contact x 10 mm ² wire Gold	10.00	7
7600.5710.0	0936010416	40A Male contact x 1 5 mm ² wire Silver	1.50	16

THIS DOCUMENT CONTAINS INFORMATION THAT IS PROPRIETARY TO MOLEX ELECTRONIC TECHNOLOGIES, LLC AND SHOULD NOT BE USED WITHOUT WRITTEN PERMISSION.

<div>REVISION:</div> <div>A1</div>	<div>EC INFORMATION:</div> <div>EC No: 640962</div> <div>DATE: 2020/07/08</div>	<div>TITLE:</div> <div>PRODUCT SPEC - 40A CRIMP CONTACTS</div>				<div>SHEET No.</div> <div>1 of 5</div>
<div>DOCUMENT NUMBER:</div> <div>936010406</div>		<div>DOC TYPE:</div> <div>PS</div>	<div>DOC PART:</div> <div>S00</div>	<div>CREATED / REVISED BY:</div> <div>DMERONI</div>	<div>CHECKED BY:</div> <div>DMERONI</div>	<div>APPROVED BY:</div> <div>PBELLOMO</div>
					TEMPLATE FILENAME: PRODUCT_SPEC[SIZE_A4] (V.4).DOCX	

Engineering No.	Material no.	Description	Wire section [mm ²]	AWG section
7600.5710.1	0936010417	40A Male contact x 1 5 mm ² wire Gold	1.50	16
7600.5711.0	0936010418	40A Male contact x 2 5 mm ² wire Silver	2.50	14
7600.5711.1	0936010419	40A Male contact x 2 5 mm ² wire Gold	2.50	14
7600.5712.0	0936010420	40A Male contact x 4 mm ² wire Silver	4.00	12
7600.5712.1	0936010421	40A Male contact x 4 mm ² wire Gold	4.00	12
7600.5713.0	0936010422	40A Male contact x 6 mm ² wire Silver	6.00	10
7600.5713.1	0936010423	40A Male contact x 6 mm ² wire Gold	6.00	10
7600.5714.0	0936010424	40A Male contact x 10 mm ² wire Silver	10.00	7
7600.5714.1	0936010425	40A Male contact x 10 mm ² wire Gold	10.00	7

Table 1

2.2 DIMENSIONS, MATERIALS, PLATINGS AND MARKINGS

The contacts are made of copper alloy silver plated or gold plated.
For the dimensions and stripping lengths see the table 2 or the relative sales drawings 7600.57XX.X.

Engineering No.	Material no.	Description	Reference Figure	Wire section [mm ²]	AWG section	Stripping length W [mm]	Inner dia. D [mm]
7600.5700.0	0936010406	40A Female contact x 1 5 mm ² wire Silver	1	1.50	16	9.0	1.75
7600.5700.1	0936010407	40A Female contact x 1 5 mm ² wire Gold	1	1.50	16	9.0	1.75
7600.5701.0	0936010408	40A Female contact x 2 5 mm ² wire Silver	1	2.50	14	9.0	2.25
7600.5701.1	0936010409	40A Female contact x 2 5 mm ² wire Gold	1	2.50	14	9.0	2.25
7600.5702.0	0936010410	40A Female contact x 4 mm ² wire Silver	1	4.00	12	9.6	2.85
7600.5702.1	0936010411	40A Female contact x 4 mm ² wire Gold	1	4.00	12	9.6	2.85
7600.5703.0	0936010412	40A Female contact x 6 mm ² wire Silver	1	6.00	10	9.6	3.50
7600.5703.1	0936010413	40A Female contact x 6 mm ² wire Gold	1	6.00	10	9.6	3.50
7600.5704.0	0936010414	40A Female contact x 10 mm ² wire Silver	1	10.00	7	15.0	4.30
7600.5704.1	0936010415	40A Female contact x 10 mm ² wire Gold	1	10.00	7	15.0	4.30

THIS DOCUMENT CONTAINS INFORMATION THAT IS PROPRIETARY TO MOLEX ELECTRONIC TECHNOLOGIES, LLC AND SHOULD NOT BE USED WITHOUT WRITTEN PERMISSION.

<div>REVISION:</div> <div>A1</div>		<div>EC INFORMATION:</div> <div>EC No: 640962</div> <div>DATE: 2020/07/08</div>		<div>TITLE:</div> <div>PRODUCT SPEC - 40A CRIMP CONTACTS</div>				<div>SHEET No.</div> <div>2 of 5</div>	
<div>DOCUMENT NUMBER:</div> <div>936010406</div>				<div>DOC TYPE:</div> <div>PS</div>	<div>DOC PART:</div> <div>S00</div>	<div>CREATED / REVISED BY:</div> <div>DMERONI</div>	<div>CHECKED BY:</div> <div>DMERONI</div>	<div>APPROVED BY:</div> <div>PBELLOMO</div>	
						TEMPLATE FILENAME: PRODUCT_SPEC[SIZE_A4] (V.4).DOCX			

Engineering No.	Material no.	Description	Reference Figure	Wire section [mm ²]	AWG section	Stripping length W [mm]	Inner dia. D [mm]
7600.5710.0	0936010416	40A Male contact x 1 5 mm ² wire Silver	2	1.50	16	9.0	1.75
7600.5710.1	0936010417	40A Male contact x 1 5 mm ² wire Gold	2	1.50	16	9.0	1.75
7600.5711.0	0936010418	40A Male contact x 2 5 mm ² wire Silver	2	2.50	14	9.0	2.25
7600.5711.1	0936010419	40A Male contact x 2 5 mm ² wire Gold	2	2.50	14	9.0	2.25
7600.5712.0	0936010420	40A Male contact x 4 mm ² wire Silver	2	4.00	12	9.6	2.85
7600.5712.1	0936010421	40A Male contact x 4 mm ² wire Gold	2	4.00	12	9.6	2.85
7600.5713.0	0936010422	40A Male contact x 6 mm ² wire Silver	2	6.00	10	9.6	3.50
7600.5713.1	0936010423	40A Male contact x 6 mm ² wire Gold	2	6.00	10	9.6	3.50
7600.5714.0	0936010424	40A Male contact x 10 mm ² wire Silver	2	10.00	7	15.0	4.30
7600.5714.1	0936010425	40A Male contact x 10 mm ² wire Gold	2	10.00	7	15.0	4.30

Table 2

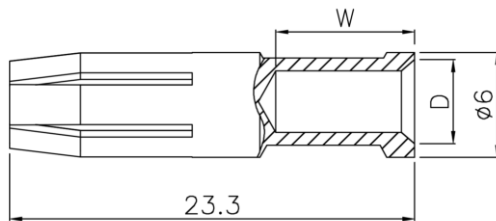

Figure 1 – Female contact

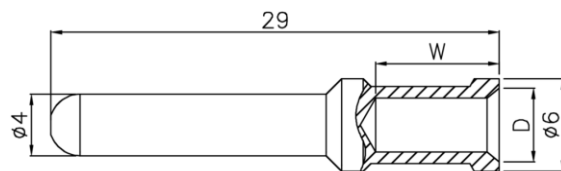

Figure 2 – Male contact

The products are CE and RoHs2 marked on the packaging.

THIS DOCUMENT CONTAINS INFORMATION THAT IS PROPRIETARY TO MOLEX ELECTRONIC TECHNOLOGIES, LLC AND SHOULD NOT BE USED WITHOUT WRITTEN PERMISSION.

<div>REVISION:</div> <div>A1</div>	<div>EC INFORMATION:</div> <div>EC No: 640962</div> <div>DATE: 2020/07/08</div>	<div>TITLE:</div> <div>PRODUCT SPEC - 40A CRIMP CONTACTS</div>				<div>SHEET No.</div> <div>3 of 5</div>
<div>DOCUMENT NUMBER:</div> <div>936010406</div>		<div>DOC TYPE:</div> <div>PS</div>	<div>DOC PART:</div> <div>S00</div>	<div>CREATED / REVISED BY:</div> <div>DMERONI</div>	<div>CHECKED BY:</div> <div>DMERONI</div>	<div>APPROVED BY:</div> <div>PBELLOMO</div>
					TEMPLATE FILENAME: PRODUCT_SPEC[SIZE_A4] (V.4).DOCX	

2.3 SAFETY AGENCY APPROVALS

The products are certified and labelled with the UL1977 (File E249674) and CSA C22.2 No. 182.3 (Master Contract 256883).

CSA mark is present only in the Canadian delivery label.

The products undergo LVD European Directive 2006/95/EC.

3.0 APPLICABLE DOCUMENTS AND SPECIFICATIONS

- Sales drawings 7600.57xx.x.
- Standard EN 60352-2:2006 EN60352-2/A1:2014
- Standard EN 60512
- European Directive 2006/95/EC
- UL1977
- CSA C22.2 No. 182.3

4.0 RATINGS

4.1 VOLTAGE

Dependent on the insert used.

4.2 CURRENT

40 Amps nominal (operating current depend on the insert used)

4.3 CABLE RANGE

Minimum 0.14 mm² (26 AWG) – Maximum 10 mm² (7 AWG)

4.4 TEMPERATURE

Operating: - 40°C to + 125°C

4.5 DURABILITY

500 mating cycles

4.6 CONTACT PLATING

The silver-plated contact has excellent conductive proprieties. During the contact's lifetime, the silver surface generates a black oxide layer due to its affinity to Sulphur. This layer is conductive smooth and very thin and is partly interrupted when the contacts are mated and unmated, thus guaranteeing very low contact resistances. In the case of very low current or voltage, small changes to the transmitted signal may be encountered.

In system where such a change to the transmitted signal could lead to faulty functions, particularly with voltage and current lower than 5V and 5mA, and also in extremely aggressive environments, the use of gold-plated contacts is recommended.

5.0 PACKAGING

Parts shall be packaged to protect against damage during handling, transit and storage. See the relevant packaging specification for packaging and labelling requirements.

THIS DOCUMENT CONTAINS INFORMATION THAT IS PROPRIETARY TO MOLEX ELECTRONIC TECHNOLOGIES, LLC AND SHOULD NOT BE USED WITHOUT WRITTEN PERMISSION.

REVISION: A1		EC INFORMATION: EC No: 640962 DATE: 2020/07/08		TITLE: PRODUCT SPEC - 40A CRIMP CONTACTS			SHEET No. 5 of 5	
DOCUMENT NUMBER: 936010406		DOC TYPE: PS	DOC PART: S00	CREATED / REVISED BY: DMERONI	CHECKED BY: DMERONI	APPROVED BY: PBELLOMO		
				TEMPLATE FILENAME: PRODUCT_SPEC\SIZE_A41 (V.4).DOCX				